



**Model Number**

**KLE-C01-1,0-2,0-K119**

Plastic fiber optic - thru-beam

**Features**

- Optimized for the detection of small parts
- Thread M4

**Series**

**Fiber optic amplifiers**

Device series SU18 ; SU18/35 ; SU19 ; ML17-LL

**Description**

**Attention:**

Fiber optics must not be twisted or kinked. Excessive tensile loads will lead to destruction. Contact with petrol or organic solvents must be prevented.



**Accessories**

**K-LA06**

Collimation lens, increases operating range by up to eight times, M4 thread

**K-LA01**

Collimation lens, increases operating range by up to four times, M2.6 thread

**K-LA02**

Collimation lens, right-angled, M2.6 thread

**OMH-LL-M4**

Mounting bracket for fiber optic cable, M4 thread

**KM4-0,5**

Metal protection for plastic fiber optics M4 x 0.5 m

**KM4-1,0**

Metal protection for plastic fiber optics M4 x 1.0 m

**Technical data**

**General specifications**

Detection range	SU18: 20 mm SU18/35: 80 mm SU19: 20 mm
Fiber optic length	l 2000 mm , adjustable
Fiber optic diameter	d 1 mm
Adapter form	00
End piece	thread
Bending radius	min. 10 mm
Fiber configuration	Fv see dimensions
Angle of divergence	67 °
Accessories provided	Cutter for plastic fiber optics

**Ambient conditions**

Ambient temperature	-55 ... 70 °C (-67 ... 158 °F)
---------------------	--------------------------------

**Mechanical specifications**

Material	
Optical face	plastic
Sheathing	PVC
Core	plastic
End piece	Stainless steel 1.4305 / AISI 303

**General information**

Scope of delivery	Fiber optic cables packaged in pairs
-------------------	--------------------------------------

**Dimensions**

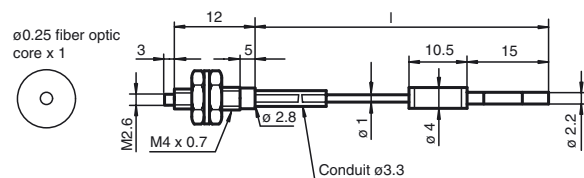

Release date: 2014-07-09 15:33 Date of issue: 2014-07-09 805875\_eng.xml

Refer to "General Notes Relating to Pepperl+Fuchs Product Information".