

# Nut

## LOCKNUT M8 NICKEL BRASS



Nut, nickel-plated brass

### Dimensions

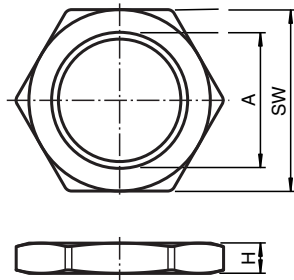

### Technical Data

Mechanical specifications	
Material	brass, nickel-plated
Dimensions	
Height	2.8 mm
Width across flats	SW 10
Thread size	A = M8 x 1.25

Release date: 2023-11-30 Date of issue: 2023-11-30 Filename: 227525\_eng.pdf

Refer to "General Notes Relating to Pepperl+Fuchs Product Information".

Pepperl+Fuchs Group  
www.pepperl-fuchs.com

USA: +1 330 486 0001  
fa-info@us.pepperl-fuchs.com

Germany: +49 621 776 1111  
fa-info@de.pepperl-fuchs.com

Singapore: +65 6779 9091  
fa-info@sg.pepperl-fuchs.com

 **PEPPERL+FUCHS**