

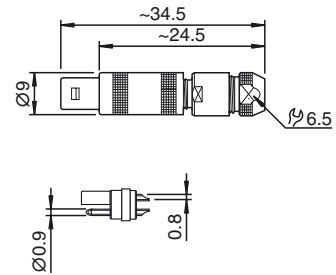

Dimensions



Model Number

FFA 0S 302 CLAL 42

Female cordset, field attachable

Features

- Push-pull self-locking system
- All-round shielding (360°) for full EMC protection

Technical data

General specifications

Number of pins	2
Construction type	Socket, straight

Electrical specifications

Test voltage	1500 V _{eff}
Operating current	I _B max. 10 A

Ambient conditions

Ambient temperature	-55 ... 250 °C (-67 ... 482 °F)
---------------------	---------------------------------

Mechanical specifications

Degree of protection	IP50
Material	
Contact surface	brass, nickel-plated
Body	chromium plated brass
Cable	
Sheath diameter	3.3 ... 4.1 mm
Core diameter	max. 0.34 mm / 22 AWG
Life span	> 5000 mating cycles

Electrical connection

